

# EPIGAP Optronik GmbH

Koepenicker Str. 325b  
 D-12555 Berlin  
 Fon: +49 (0)30 657637 60  
 Fax: +49 (0)30 657637 70  
 sales@epigap-optronic.de



## Data Sheet (Preliminary)

### LED Chip Green

### EOLC-572-19-10

Rev. 02, 2014

Radiation	Type	Electrodes
Green	AlInGaP/GaAs	p (anode) up

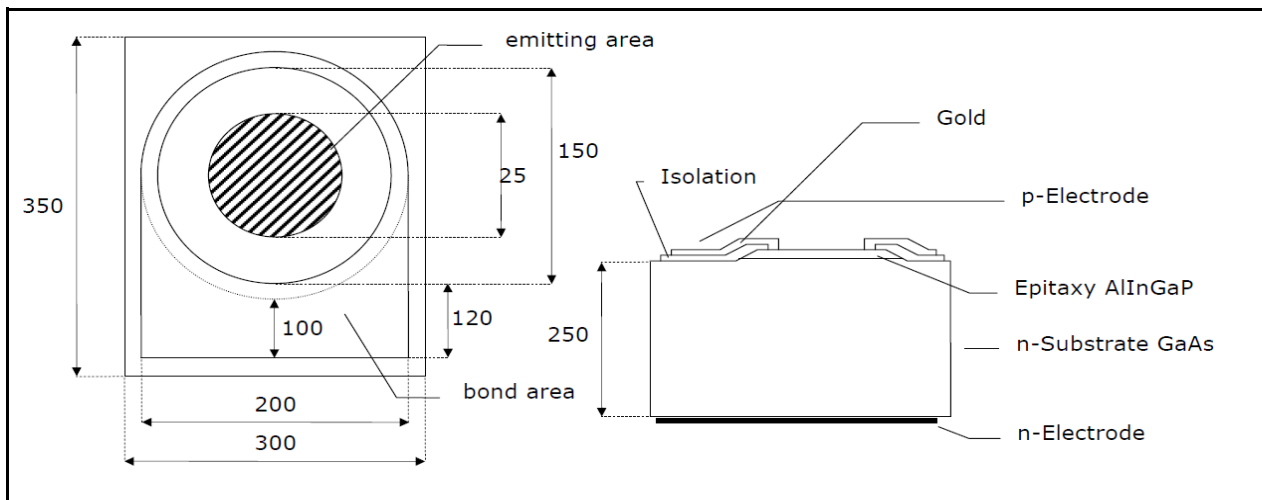

### Optical and Electrical Characteristics

$T_{amb} = 25^{\circ}\text{C}$ , unless otherwise specified

Parameter	Symbol	Cond.	Min	Typ	Max	Unit
Forward voltage	$V_F$	$I_F=20\text{ mA}$		2.1	2.5	V
reverse current	$I_R$	$V_R=5\text{ V}$			100	$\mu\text{A}$
Luminous intensity*	$I_V$	$I_F=1\text{ mA}$		90		$\mu\text{cd}$
Luminous intensity*	$I_V$	$I_F=20\text{ mA}$		3		mcd
Dominant wavelength	$\lambda_D$	$I_F=20\text{ mA}$	567	572	577	nm

\*Brightness measured on gold plate

### Packing

Dice on adhesive film with wire-bond on top



We reserve the right to make changes to improve technical design and may do so without further notice. Parameters can vary in different applications. All operating parameters must be validated for each customer application by the customer.